

EM 1750 Mooring Buoy

Corilla's innovative, rotationally moulded plastic mooring buoys now make their predecessors obsolete. Suited to inner harbour and river applications, their design is durable and lightweight.

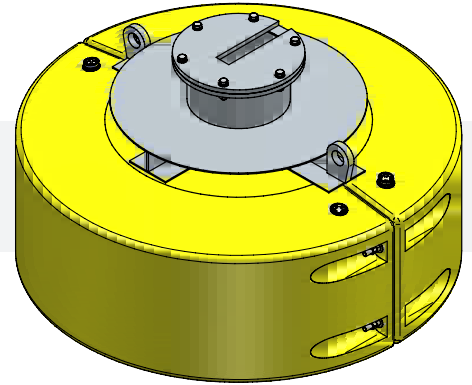

Key Dimensions

Diameter mm	1750
Overall weight Kgs	400
Reserve buoyancy weight Kgs (sealed)	1546
Waterline above datum mm (typical)	340
Chain size mm (typical)	22/30
Chain size dependent on water depth or spec	

Steel Core 1

Designed for long life, manufactured from grade 43A mild steel complete with 2 lifting eyes. The chain passes through the central tube and is locked in place by the lock plate and a shackle at the top. This design has a replaceable chain wear plate which can be removed and replaced as necessary.

Steel Core 2

Designed for long life, manufactured grade 42A mild steel with two lifting pad eyes (test certificates on request). Finish: hot dipped galvanised after manufacture, to BS EN ISO 1461-1999.

Float Collar

Rotationally moulded with specially formulated extra high UV stabilised virgin polyethylene. Foam filled with marine safety approved close-cell foam.

Optional Extras

Two coats ZINGA on steel core to substantially increase service life.

Mooring

To achieve mooring height of 340 mm above datum at high tide the floated mooring weight should be approximately 50% above the reserve buoyancy.

Design Feature

This design of float collar allows for added collars to each individual buoy to increase floatation.

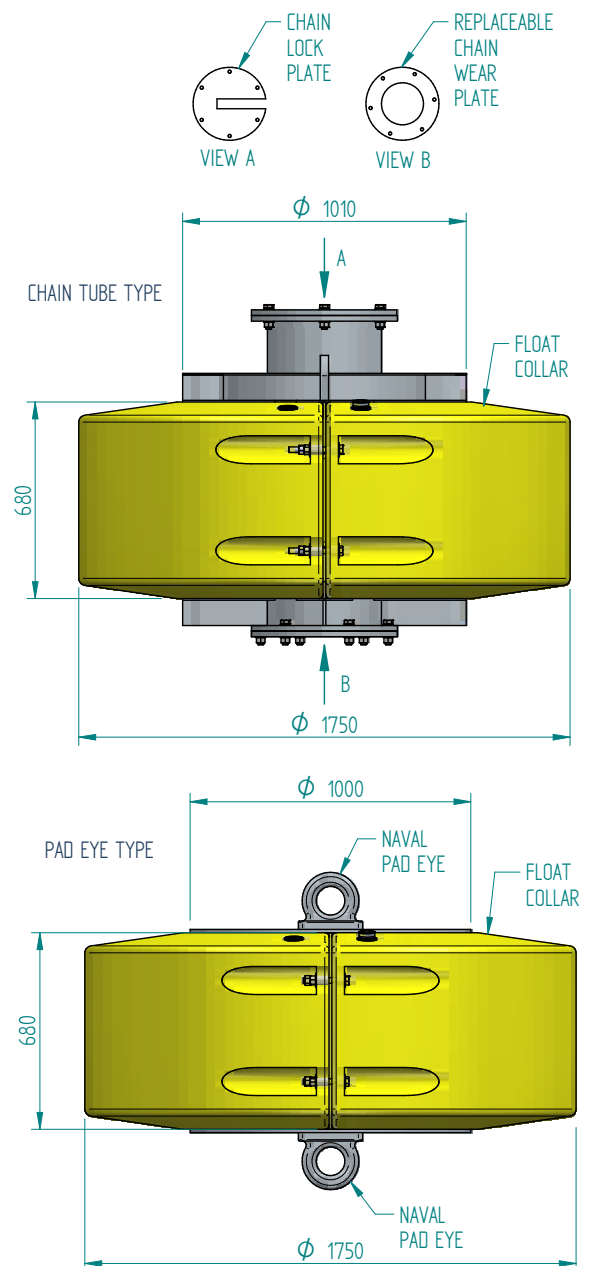

Contact

Email: sales@corillamarine.com

Phone: +44 (0)1246 575646

www.corillamarine.com

Victoria St, Pontycymer, Bridgend,
Mid Glamorgan, CF32 8LR, United Kingdom

